

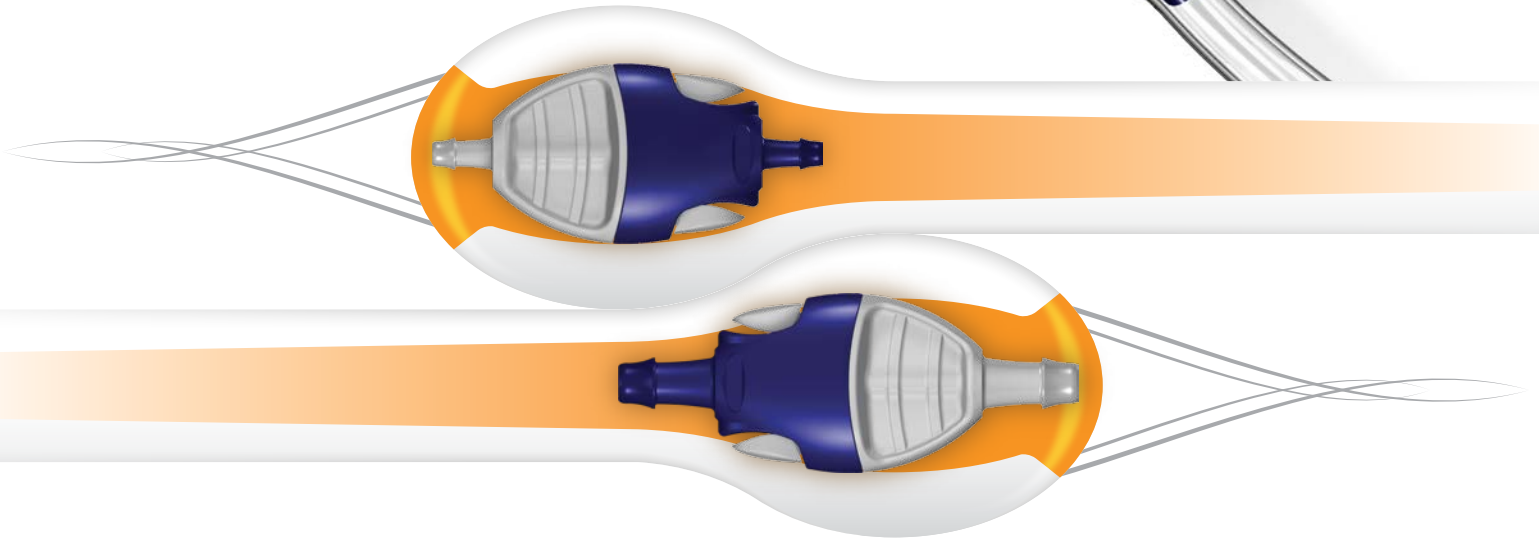

Nordson MEDICAL introduces a new concept in quick connect fittings for small-bore applications. The SBL Series connector system is so intuitive that users just automatically know how to operate it the minute they pick it up.

THE SBL SERIES

QUICK CONNECTS



FEATURES

Ergonomic Design

Versatile

Nylon & Buna-N Materials

Lubricated O-ring

BENEFITS

Easy and intuitive to connect and disconnect

Two sizes fit 1/8" and 3/16" tubing IDs
180° of tube orientation

Gamma radiation stable, EtO compatible

Long service life

SPECIFICATIONS

Materials: Body, Nylon. O-ring, Buna-N

Tubing Sizes: 1/8" (3.2 mm), 3/16" (4.8 mm)

Leak Resistance: <.007 psi/0.05 kPa/sec.

Minimum Bore: 0.96"

Tensile Pull Load: 27 lbs

Working Pressure: Up to 25 psi

Life Cycle Tested: Up to 1,500 times

For more information and samples, please visit www.nordsonmedical.com



SBL Series quick connect fittings are cost effective and designed to meet your needs for a reusable component for small-bore applications in all fluid delivery areas. Contact us today for free samples and make this exciting new fluid link part of your next design.

THE SBL SERIES QUICK CONNECTS

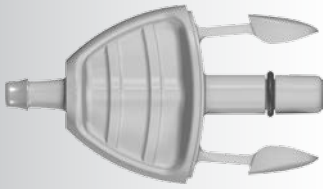

SBLM013-001
Side Latch Quick Connect Male
500 Series Barb
1/8" (3.2 mm) ID Tubing, Grey Nylon
Dimensions A: .929" B: 2.037" C: .468"
Also available in Blue Nylon - SBLM013-002



SBLF013-CM030
Side Latch Quick Connect Female
500 Series Barb
1/8" (3.2 mm) ID Tubing, Blue Nylon
A: .935" B: 2.037" C: .467"
Also available in Grey Nylon - SBLF013-8B

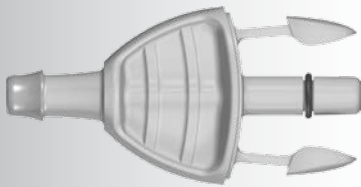

SBLM035-001
Side Latch Quick Connect Male
500 Series Barb
3/16" (4.8 mm) ID Tubing, Grey Nylon
A: .929" B: 2.421" C: .468"
Also available in Blue Nylon - SBLM035-002



SBLF035-CM030
Side Latch Quick Connect Female
500 Series Barb
3/16" (4.8 mm) ID Tubing, Blue Nylon
A: .935" B: 2.421" C: .467"
Also available in Grey Nylon - SBLF035-8B

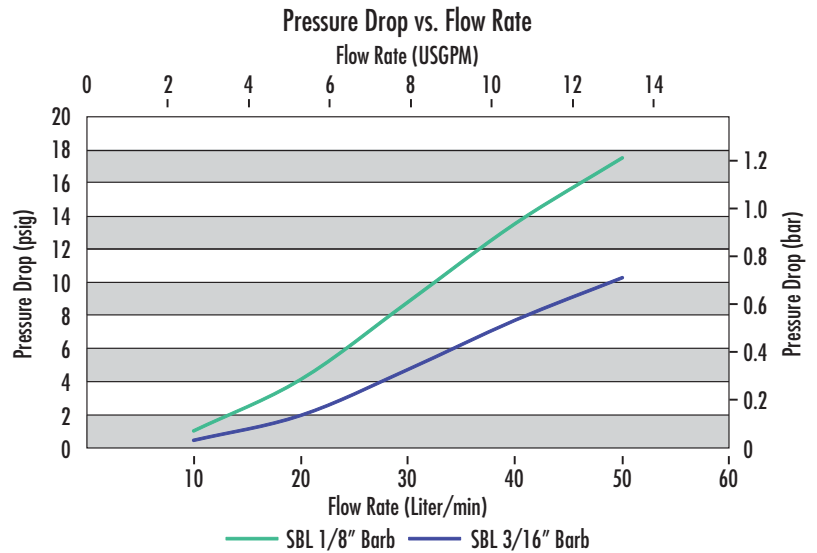
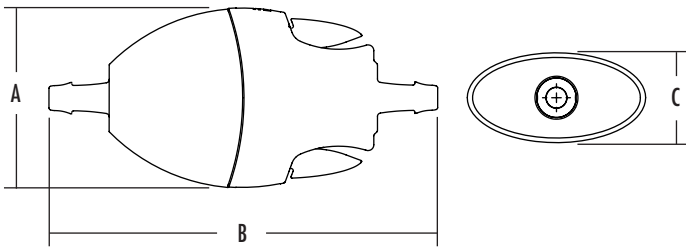

The data presented here are for reference only. They are not presented as a specification guideline. As your application conditions are beyond Nordson MEDICAL's control, it is imperative that you test products in their specific environments to determine suitability for a particular use. For further information on Nordson MEDICAL warranties, please review section 10 of the "Terms and Conditions of Sale" on the Nordson MEDICAL website at http://www.nordsonmedical.com/technical/orders/vp_terms.pdf or Nordson MEDICAL's most recent catalog.

中国代理商:

捷阔流体技术 (深圳) 有限公司



📍 深圳市龙岗区五和大道4012号
IOT物联网产业园一栋
☎ +86 755 8452 8460/80
✉ enquiry@gefa-ultrapure.com.cn
🌐 www.gefa-ultrapure.com.cn

